

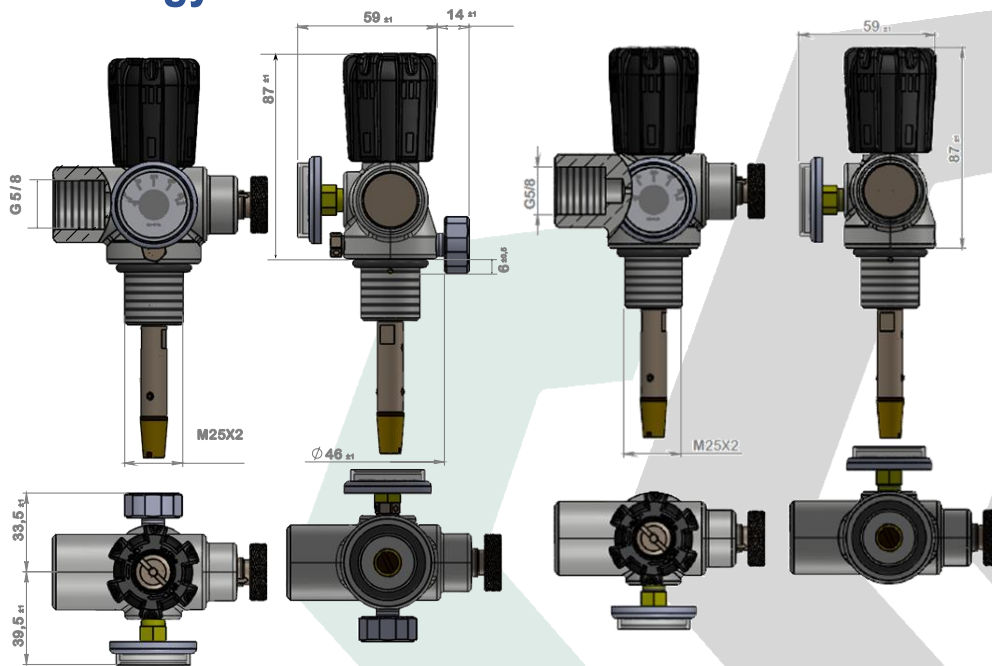

AIRGUN



NEW AIRGUN VALVE REFILL 300Bar a concentrate of technology



2 GAUGES

1 GOUGE

NEW PROJECT THAT HAS NEW FEATURES AND ENHANCEMENTS.

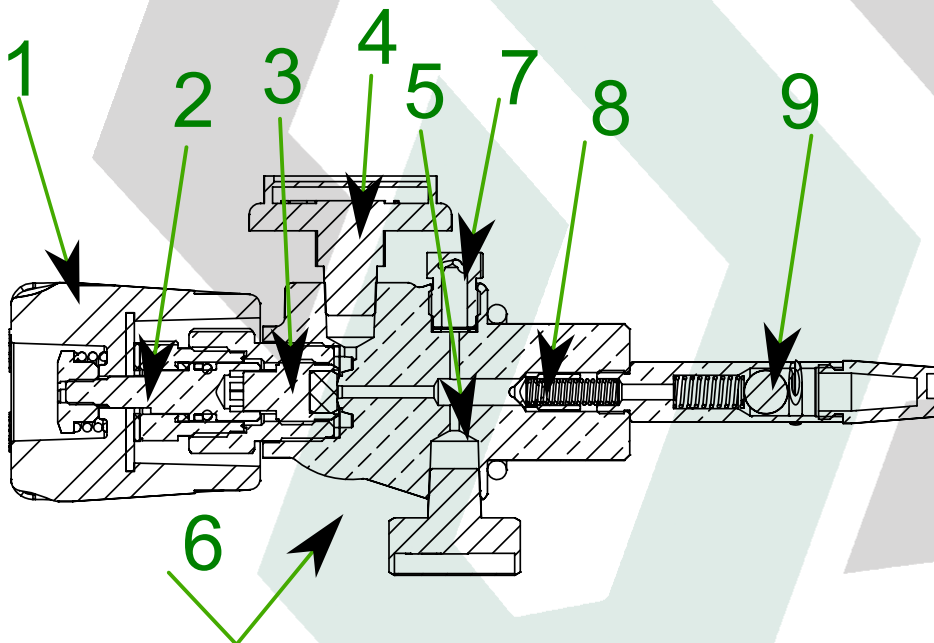

STENGHT

1 The knob placed at the top to simplify the opening and closing maneuver even in the presence of a protective cap. The knob has been totally redesigned with a new design for improved grip even with wet hands. The new knob is part of a total development of our valves,

2 we go from 4 mm² shafts to 6 mm² shafts, the stress at torsion failure increases from 90N to 200N.

3 Il porta pastiglia con attacco quadrato per incrementarne la forza e la stabilità

The pad holder with square attachment to increase its strength and stability

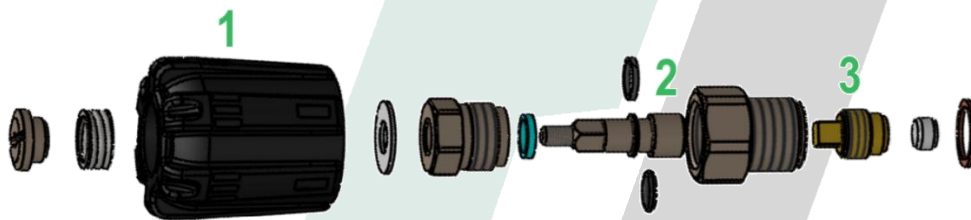

FEATURES.

4 Outlet pressure gauge to directly check the charging pressure

5 Inlet pressure gauge to always keep an eye on the beautiful cylinder charge status

6 Discharge valve

In order to discharge the hose is equipped with a totally metal discharge valve with side discharge

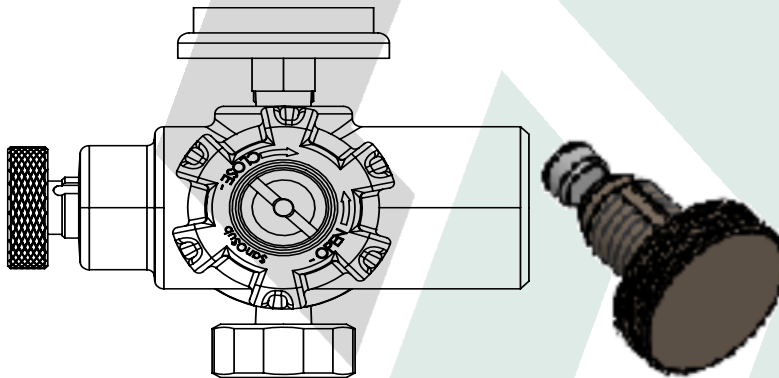

CONCENTRATE OF SAFETY

7 Burst disk calibrated to 316Bar ,as the pressure generated by the compressors increases, it is an indispensable safety

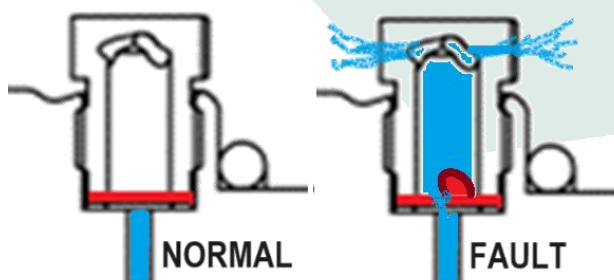

FLOW REDUCER

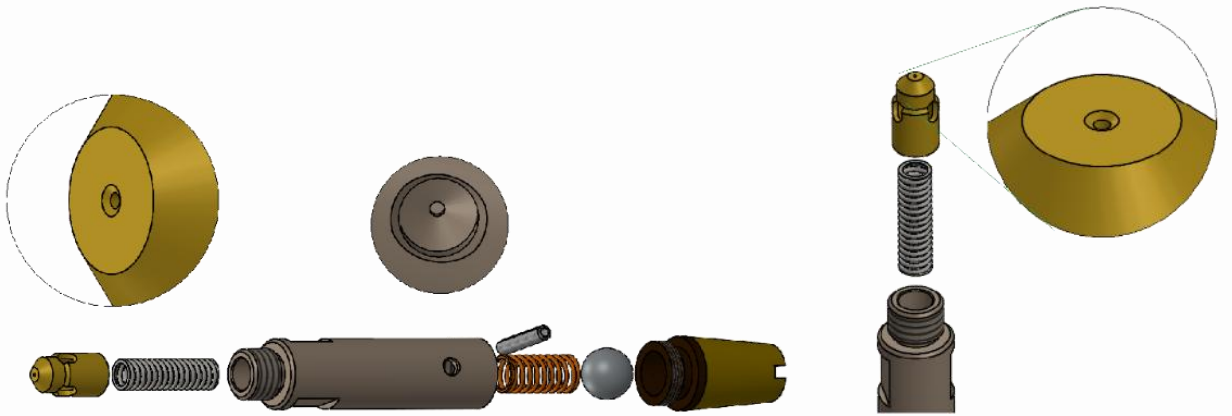

8 The flow regulator is integrated into the valve body , its function is to open fully during cylinder filling and to narrow the passage, via a pre-calibrated hole. during outlet refilling.
Reduces the flow, preserves the AIRGUN charging system, increases reload times by avoiding overheating and water hammer

EXTRA FLOW VALVE

9 A further safe development is the Extra flow valve

The draft was developed to be an additional protection, should the cylinder fall and the valve shear off at the base, it prevents the outflow from the cylinder from generating a jet thrust that is dangerous to property and people. In case the valve is damaged, the outflow pushes the sphere, held in the rest position by the calibrated spring, until the partial closure of the dipstick , a micro-hole still allows the discharge of the air counted in the cylinder with a reduced flow, this solution reduces to extremely low values of the jet thrust excluding or at least minimizing damage to property and people.

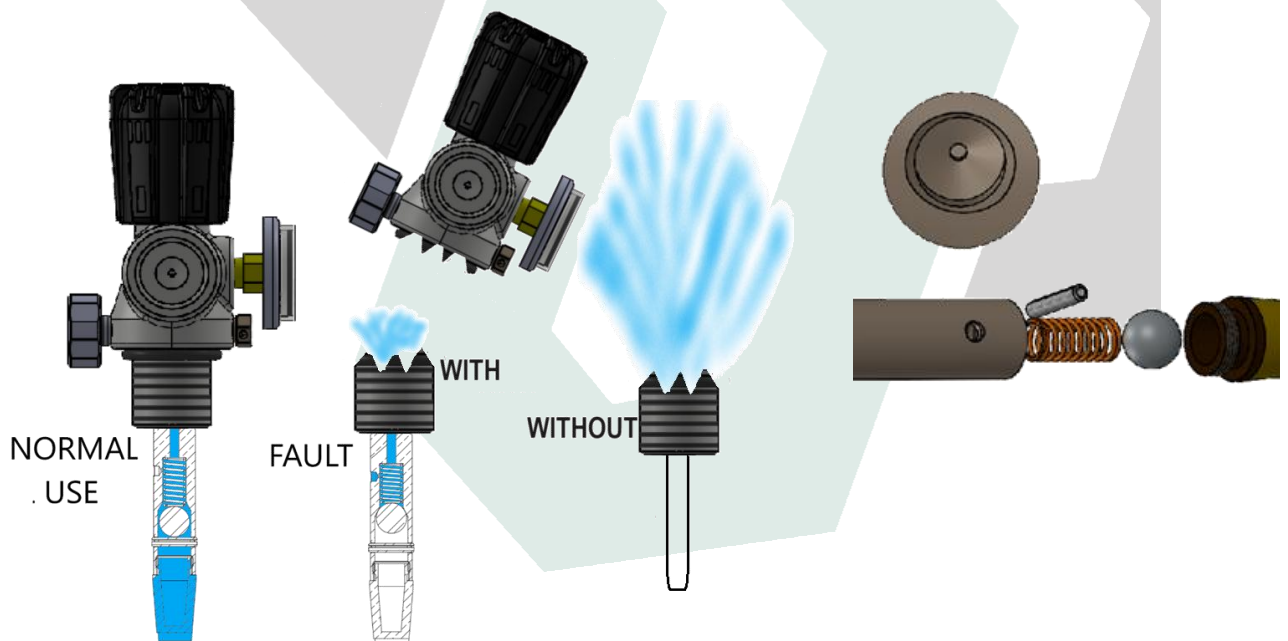

AIRGUN VALVES DIRECT CYLINDER ATTACHMENT

Code	Description	Inlet	outlet
VG.64A.60251	VAL GUN 300BAR M25X2 1 MAN EXTRA FLOW BURN DISK REDUCER 0.25	M25X2	G5/8
VG.64A.60252	VAL GUN 300BAR M25X2 2 MAN EXTRA FLOW BURN DISK REDUCER 0.25	M25X2	G5/8
VG.64A.60253	VAL GUN 300BAR M25X2 1 MAN BURN DISK REDUCER 0.25	M25X2	G5/8
VG.64A.60254	VAL GUN 300BAR M25X2 2 MAN BURN DISK REDUCER 0.25	M25X2	G5/8
VG.64A.60255	VAL GUN 300BAR 5/8 UNF 2 MAN EXTRA FLOW BURN DISK REDUCER 0.25	5/8UNF	G5/8
VG.64A.60256	VAL GUN 300BAR 7/8 UNF 2 MAN EXTRA FLOW BURN DISK REDUCER 0.25	7/8UNF	G5/8
VG.64A.60257	VAL GUN 300BAR M18X1,5 2 MAN EXTRA FLOW BURN DISK REDUCER 0.25	M18x1,5	G5/8
1153	FITTING G5/8 30BAR-1/4'	G5/8	G1/4f
1979	ADAPTER FITTING G1/4-G1/8 X WHIPS	G1/4m	G1/8m
CS.100.15606	TRANSFER HOSE TERMP O,5 MF21/8"-1/8" PE 300ba	1/8"	1/8"
9016	SERVICE KIT M12X1.25 6MM2	0,00	0,00
2900	AIRGUN VALVE DISCHARGE SCREW	0,00	0,00
2030A	FISHING TUBE EX FLOW M8X0,75	M8	0,00

A STORY BEHIND THE DEVELOPMENT



Code	Description	Inlet	outlet
VS.309.10119	VALVE LAT SX M25x2 300bar AIRGUN W/GAUGE	M25X2	G5/8
VS.309.10119A	VALVE LAT SX M25x2 200bar AIRGUN W/GAUGE	M25X2	G5/8
VS.309.10116	VALVE LAT SX M18x1.5 300bar AIRGUN W/GAUGE	M18X1,5	G5/8
VS.309.10116A	VALVE LAT SX 5/8 unf 300bar AIRGUN C/M BD	5/8 unf	G5/8







CONTROLLED REDUCED FLOW

Code	Description	Inlet	outlet
VS.164.18050	IN LINE VALVE VERT . M25X2 300bar AIRGUN	M25X2	1/8"
VS.164.18050A	IN LINE VALVE VERT . M18X1.5 300bar AIRGUN	M18X1,5	1/8"
VS.164.18048	IN LINE VALVE VERT 7/8"UNF 300bar AIRTANK	7/8" UNF	1/8"

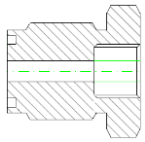
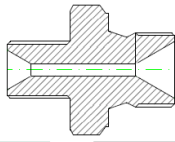

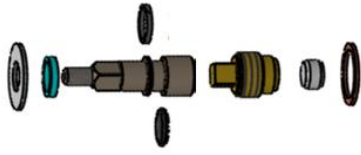
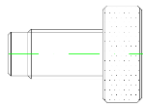
ACCESSORIES

Code	Description	Inlet	outlet
1153	 FITTING G5/8 300 BAR-1/4'	G5/8	G1/4f
1979	 ADAPTER FITTING G1/4-G1/8 X WHIPS	G1/4f	G1/8m
CS.100.15606	 TRANSFER HOSE TERMP O,5 MF20 1/8"-1/8" PE 300ba	1/8"	1/8"
9016	 SERVICE KIT M12X1.25 6MM2	-	-
2900	 AIRGUN VALVE DISCHARGE SCREW	-	-
2030A	 FISHING TUBE EX FLOW M8X0,75	M8	-

GENERAL TERMS AND CONDITIONS OF SALE

1.0 CONTRACTS:

1.1 EVERY CONTRACT OF SALE SHALL ALWAYS BE DEEMED TO HAVE BEEN MADE AND MADE PERFECT AT THE SEAT OF THE SELLER WHEREVER THE COMMISSION IS GIVEN. ALL OF THE FOLLOWING TERMS AND CONDITIONS, NONE EXCLUDED OR EXCEPTED, ARE DEEMED TO BE IMPLICITLY ACCEPTED WITH THE PLACING OF THE ORDER, EVEN IF THE ORDER FORMS OF THE CLIENT CONTAIN DIFFERENT CLAUSES FROM THOSE STATED HERE. 1.2 THE MINIMUM ORDER AMOUNT SHALL BE €150.00.

2.0 DELIVERIES

2.1 THE DELIVERY TERMS INDICATED IN THE ORDER ARE INDICATIVE AND NOT BINDING; THEY SHALL BE RESPECTED SUBJECT TO THE AVAILABILITY OF THE MATERIALS NECESSARY FOR PRODUCTION AND ANYTHING ELSE PERTAINING THERETO. ANY AND ALL CHANGES MADE BY THE PURCHASER TO THE DELIVERY TERMS AFTER THE ORDER HAS BEEN PLACED SHALL BE INVALID.

2.2 DELAYS DUE TO FIRES, STRIKES, DELAYS IN RECEIPT OF GOODS, EXPORT AND IMPORT RESTRICTIONS OR OTHER CAUSES OF FORCE MAJEURE SHALL ENTITLE THE SELLER TO SHIFT DELIVERY DATES, RELEASING IT FROM ANY LIABILITY. EVEN IN THE EVENT OF SUCH DELAYS, THE BUYER SHALL ALWAYS BE OBLIGED TO COLLECT THE ORDERED AND COMMITTED QUANTITY OF GOODS IN FULL.

2.3 IN NO CASE AND FOR NO REASON IS THE SELLER OBLIGED TO PAY COMPENSATION OF ANY KIND FOR ANY DIRECT OR INDIRECT DAMAGES DUE TO DELIVERY DELAYS, BECAUSE THE TERMS INDICATED AND ACCEPTED AT THE TIME THE ORDER IS TAKEN ARE NOT BINDING.

2.4 IF DISPATCH OR DELIVERY TAKES PLACE AFTER THE DEADLINE STIPULATED BY ORDER OF THE PURCHASER, THE SELLER SHALL BE LIABLE FOR STORAGE COSTS OF 1.5% OF THE INVOICE AMOUNT OF THE GOODS FOR EACH MONTH OF STORAGE.

3.0 SHIPMENT AND RETURN

3.1 GOODS SHALL BE DEEMED DELIVERED EX WAREHOUSE OF DEPARTURE UNLESS OTHERWISE AGREED. THEY ALWAYS TRAVEL ON BEHALF AND AT THE RISK OF THE PURCHASER, EVEN IN THE CASE OF AGREED HOME DELIVERY. THE DELIVERY SHALL BE DEEMED TO HAVE TAKEN PLACE WITH THE DELIVERY OF THE GOODS TO THE CARRIER INDICATED BY THE PURCHASER OR, IN THE ABSENCE OF TIMELY NOTIFICATION, CHOSEN BY THE SELLER. ALL GOODS SHALL BE SHIPPED BY THE SELLER WITHOUT INSURANCE; IF INSURANCE IS REQUESTED, ANY RESULTING EXPENSES SHALL BE BORNE BY THE PURCHASER.

3.2 COMPLAINTS REGARDING THE STATE OF THE PACKAGING, QUANTITY OR NUMBER OF PIECES MUST BE DECLARED ON THE DELIVERY NOTE AND COUNTERSIGNED BY THE CARRIER; THE COMPANY MUST BE INFORMED BY E-MAIL WITHIN SEVEN DAYS OF RECEIPT OF THE GOODS UNDER PENALTY OF FORFEITURE OF ANY RIGHT TO REIMBURSEMENT OR REPLACEMENT.

3.3 Returns of goods are not permitted unless specifically agreed with the Seller. Any returned goods shall always travel at the exclusive risk and peril of the purchaser and shall only be accepted carriage paid.

3.4 Complaints or any other disputes that may arise as a result of the sale-purchase relationship governed by these conditions shall not entitle the purchaser to suspend or in any case delay payments as agreed.

4.0 Prices:

4.1 List prices may be varied or changed without any obligation to give prior notice to the client. Prices and all other conditions relating to an order are not binding for any subsequent orders of the same items. Any different agreements do not constitute a derogation from this principle and must be considered limited to the particular case. The prices indicated on the order or in any case agreed upon refer to goods delivered ex-warehouse and shall be borne by the purchaser, in addition to transport costs, packaging, duties, customs tariffs, insurance, special duties, taxes of any kind and in general all tax and ancillary charges of the contract, the prices are subject to revision in the event of changes in the exchange rate.

5.0 Terms of Payment

5.1 Payments shall be made under the conditions set forth in the order exclusively to the cash office of the Seller, the transmission of the sums being at the Purchaser's risk. The possible issuing of drafts constitutes a unilateral initiative of the Seller for a more convenient form of payment and does not imply any shift of territorial jurisdiction. Any discounts granted refer only to the amounts of the goods. No discounts or rebates not agreed upon and/or forfeited shall be recognised.

5.2 In the event of delayed payment, annual interest shall automatically be charged at the official discount rate plus 4 percentage points from the due date, without any need for a formal notice of default. This is without prejudice to the right of the manufacturer, in the event of payment arrears, to suspend any ongoing supply.

6.0 Guarantees

6.1 The products are tested before shipment, are guaranteed in accordance with the technical documentation supplied and are provided with the identification plate, affixed by the manufacturer which may under no circumstances be removed.

6.2 The duration of the guarantee is twelve months from the date the products are collected from the Seller's premises and is limited to the replacement, ex Seller's warehouse, of those parts whose defects are ascertained.

6.3 Parts that are normally subject to wear and tear are excluded from the guarantee and the guarantee in any case lapses if there has been use that does not comply with the indications in the catalogues or instruction sheets, contamination with improper materials, bad installation or maintenance, or mechanical breakage, modification or tampering.

6.4 The terms for the return of materials acknowledged to be defective and/or in need of repair shall be agreed with the purchaser; however, they shall be understood as identifying the same as the delivery terms.

6.5 In the event of a partial or total recall of a potentially defective batch, the costs associated with tracing the product are excluded from the reimbursement, and remain the responsibility of the purchaser.

6.6 If the purchaser's complaint is acknowledged to be justified, the seller is entitled to repair or replace the parts found to be defective.

6.7 Interventions for replacement under warranty shall be carried out ex vendor's warehouse and deliveries shall be agreed in advance with the same.

6.8 Replacement of goods is not permitted unless specifically agreed with the Seller.

6.9 Compensation for any damage to the purchaser shall not exceed the invoice price of the disputed products.

6.10 This guarantee excludes all other possible liability of the Seller in connection with the delivered products.

6.11 In particular, the purchaser may not make any other claims for damages, price reductions, termination of the contract or suspension of payments.

6.12 If payments are suspended, the guarantee shall be automatically suspended until payments are regularised.

6.13 Under no circumstances shall the Seller be liable for indirect or consequential damage.

7.0 Disputes

7.1 The place of jurisdiction for any dispute shall be Milan.

"Pursuant to articles 1341, 1342 and s.s. of the Italian Civil Code, the following clauses are specifically approved: Deliveries 2.3 Shipment and return 3.1 - 3.4 - Payment conditions 5.2 - Guarantees 6.2 - Disputes 7.1".

SAN-O-SUB MBB IS A MECHANICAL COMPANY WITH PRODUCTION HEADQUARTERS IN ITALY, FOUNDED IN MILAN IN 1934, FOR THE PRODUCTION OF INDUSTRIAL GEARBOXES, VALVES AND MEDICAL PRODUCTS.

Info: +39 02 4452075
Sales: +39 02 4454057

Via Leonardo da Vinci. 168 -
20090 Trezzano sul Naviglio (Milano)

Info: sanosub@sanosub.com

